



EXCLUSIVE



benimar

Tessoro ... A Noble Gem

2017 Range



Tessoro ... A Noble Gem

Building upon the tremendous success of the Benimar Mileo range, Ireland's Premier Motorhome Dealership AnchorPoint Motorhomes are proud to bring an exciting new Ford range to Irish shores...Tessoro.

Benimar is part of the Trigano Group that produces its motorhomes from their modern factory facilities on the beautiful Peñíscola coastal region of Spain. All Benimar models come with an exceptionally high specification customers have come to expect from a Marquis Special Edition. These Exclusive models offer modern layouts to suit both couples and families.

Launching for the 2017 season is a totally new range of 5 Ford based coachbuilt motorhomes. All models will be powered by the new Ford Euro 6 (AdBlue) 170PS engine and offer a stylish silver grey cab.

Safety, comfort and style come as standard on the new Tessoro range. All models are fully equipped with driver and passenger airbags, cruise control, ABS brakes, ESC and Hill Start Assist. Plus, for your touring comfort air-conditioning is standard and the stylish Gaho fabric offers a modern and luxurious interior.

Benimar Motorhomes have EU Type approval and meet the relevant Euromorn (EN) standards.

To find out more visit: www.anchorpointmotorhomes.com

2 | Tessoro 2017 Range | www.anchorpointmotorhomes.com



Contents

4	2017 Tessoro Range Images
8	Exclusive Enhancements & Key Features
10	Range Specification
12	Body Construction
14	Warranty Info
15	Euro 6 (Adblue)



99% WOOD-FREE
CONSTRUCTION



View videos
online now

For more information and full video
reviews on all models, please visit:
www.anchorpointmotorhomes.com



Tessoro 413 Front To Rear



Tessoro 486 Kitchen



Tessoro 463 Washroom



Tessoro 494 Island Bed



Tessoro 494 Front Lounge



Tessoro 494 Front Lounge



Tessoro 481 Kitchen



Tessoro 413 Washroom

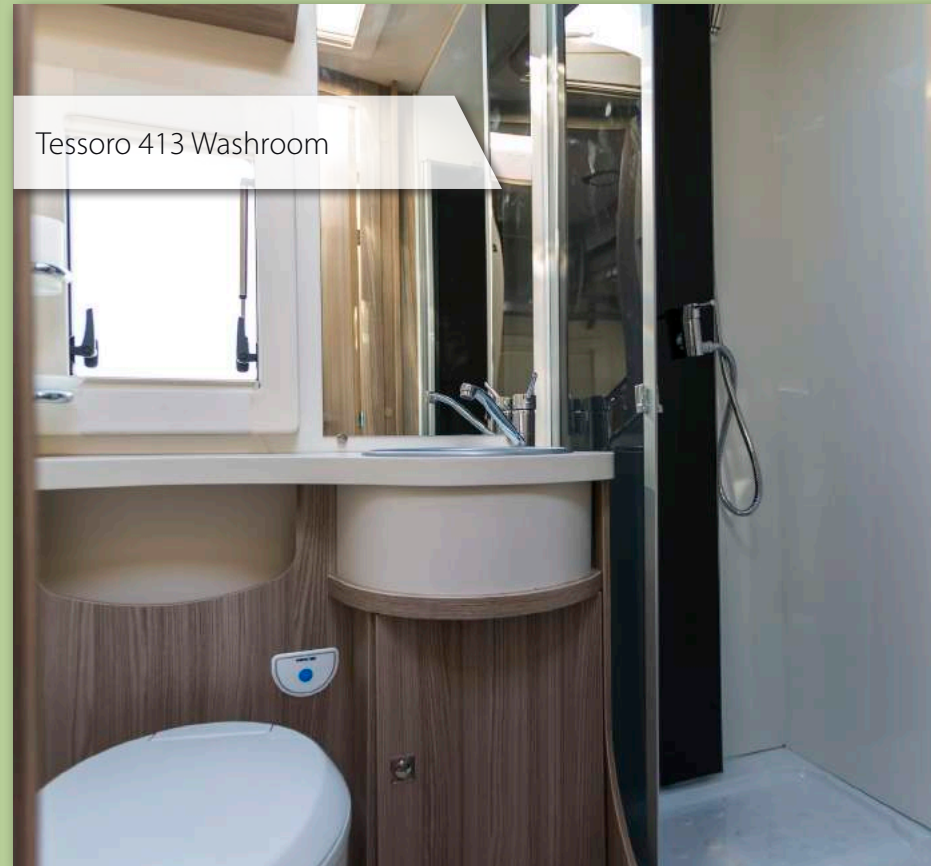

Tessoro 463 Dropdown Bed



Tessoro 463 Front Dining



Tessoro+ Exclusive Enhancements

- **NEW** Ford 2.0L 170ps Euro 6 engine with AdBlue technology with LED daytime running lights
- Stylish silver grey cab
- Drivers and Passengers Airbags
- Cruise control
- ABS, ESC and Hill Start Assist
- AM/FM Radio with USB connection and Bluetooth handsfree
- Media function controls on steering wheel
- 16" Alloy wheels
- Increased rear axle width of 1980mm for better stability
- Puncture kit on all models
- Rear view observation camera
- Cab air-conditioning
- Dometic Deluxe windows
- Stylish Marel ash and chocolate style furniture
- Metal drawer runners with soft closing system
- Skyview opening cab sunroof
- Space saving drop down beds across the range
- 140L fridge with automatic energy selection across the range
- Thetford 18L wheeled cassette toilet with electric flush
- Solar panel
- Webasto 4kW heater with Truma combi heater on Tessoro 463
- 120L fresh water tank isolated and heated with level sensor
- 105L waste water tank with level sensor



Modern Cabo interior fabrics



Stylish Silver Grey Cab



170ps engine as standard



Drop down bed options

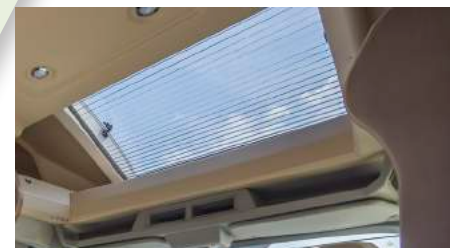

Skyview opening cab sunroof

+ Key Features

Chassis Cab

- **NEW** Ford 2.0L 170ps Euro 6 engine with AdBlue technology with LED daytime running lights
- Stylish silver grey cab
- AM/FM Radio with USB connection and Bluetooth handsfree
- Media function controls on steering wheel
- Driver and passenger airbags
- Cruise control
- ABS brakes, ESC and Hill Start Assist
- Increased rear axle width (1980mm) for better stability
- Remote central locking of the cab doors and immobiliser
- Puncture kit on all models
- 16" Alloy wheels
- Heated wing mirrors
- Fog lights
- Rear view observation camera
- Heavy duty chassis extension (413, 463, 486 & 494)
- 70 litre Diesel tank
- Electric windows and mirrors
- Manual Air-Conditioning
- Height adjustable steering wheel
- Fully upholstered swivel captain chairs with two arm rests and height adjustment
- Door pockets with bottle holders and upper storage in cab
- 2 x USB ports
- Gear stick and steering wheel in leather finish
- Remis concertina blinds on cab and windscreen

Body Construction

- GRP and 99% wood free construction
- 25mm XPS insulation on sidewalls
- 53mm XPS insulation on floor and roof
- High impact, scratch resistant floor covering
- 120 litre fresh water tank isolated and heated with level sensor
- 105 litre waste water tank with level sensor
- Lap and diagonal seat belts to all Forward facing designated passenger seats (413 rear facing seat with lap belt only)
- High and low fixing points for optional rear mounted cycle rack
- Spacious rear garage with ample storage for leisure equipment (413, 463, 486 & 494)
- Exterior access lockers
- Single key locking for habitation door
- ABS lower mounted rear panel with integral lights
- High level brake light
- Colour coded side skirts
- Removable entrance mat
- Double glazed opening windows with nightlatch ventilation
- Blinds and flyscreens to all windows
- Flyscreen to entrance door
- Gas compartment for 1 x 13kg gas bottle (exc 463 which can fit 2 x 13kg gas bottles)
- Gas regulator suitable for butane or propane

Living Area

- Dometic Deluxe windows
- Stylish Marel ash and chocolate style furniture
- Modern Gaho interior fabrics
- Dometic Mini Heki rooflights
- Drop down beds standard across the range with removeable aluminium ladder
- Secure positive catches on all furniture doors
- Skyview opening cab sunroof
- Multi directional sliding table
- High resilience foam in seats and backrests (130mm/5")
- TV bracket

Electrics & Plumbing

- 220v UK sockets
- 2 x 12v sockets
- LED lighting throughout
- TV aerial socket and antenna pole
- Mains consumer unit with mains isolator
- 12v fuse board
- Large and easy to read control panel near to the entrance door
- Low energy consumption LED lighting
- Webasto 4kW diesel heater (413, 486, & 494)
- Eberspächer 3.5kW diesel heater (481)
- Truma combi 4kW heater (463)
- Truma gas water heating
- Pressurised fresh water system with self-filling pump
- Isolation taps for all gas appliances
- Solar panel

Bathroom

- Thetford cassette toilet with electric flush and 18 litre wheeled holding tank
- Chrome finish brass mixer taps and shower head
- Rooflight with flyscreen
- Towel holder
- Generously sized washbasin with single door cupboard
- Fully separate shower

Kitchen

- Metal drawer runners with soft closing system
- 3 gas burner hob with glass lid and oven with grill
- Stainless steel sink with glass lid
- 140 litre fridge with automatic energy selection and bottle compartment
- Slide out larder rack storage (413, 481, 486)

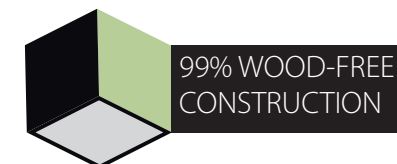

Tessoro + Specification

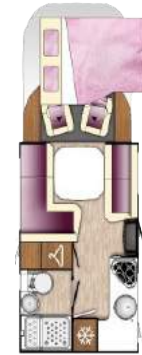

Model	Tessoro 413	Tessoro 463	Tessoro 481
Ford Euro 6 AdBlue 2.0L Diesel Engine	170ps Manual	170ps Manual	170ps Manual
Designated Passenger Seats	5	4	4
Berths (sleeping positions)	5	4	4
Overall Length	6.52m/21'4"	7.48m/24'6"	5.99m/19'7"
Overall Width (mirrors folded)	2.30m/7'6"	2.30m/7'6"	2.30m/7'6"
Overall Height (Exc TV Aerial)	2.89m/9'5"	2.89m/9'5"	2.89m/9'5"
MTPLM (A)*	3500kg	3500kg	3500kg
Mass in Running Order (B)	3000kg	3200kg	2935kg
Maximum User Payload (A-B)	500kg	300kg	565kg
Unladen Weight	2800kg	3000kg	2735kg
Maximum Trailer Weight	2000kg	2000kg	2000kg
Gross Train Weight	5500kg	5500kg	5500kg

Bed Sizes			
Hinged Roof Bed	1 x double 1390mm x 1900mm	1 x double 1390mm x 1900mm	1 x double 1390mm x 1900mm
Front Lounge Bed	1 x Single 900mm x 2100mm	N/A	1 x Double 1400mm x 2100mm
Fixed Rear Bed	2 x Single 900mm x 2100mm	2 x Single 800mm x 1900mm	N/A



Tessoro 486	Tessoro 494
170ps Manual	170ps Manual
4	4
4	4
6.99m/22'9"	7.48m/24'6"
2.30m/7'6"	2.30m/7'6"
2.89m/9'5"	2.89m/9'5"
3500kg	3500kg
3100kg	3240kg
400kg	260kg
2900kg	3040kg
2000kg	2000kg
5500kg	5500kg

1 x double 1390mm x 1900mm	1 x double 1390mm x 1900mm
1 x Double 1400mm x 2100mm	N/A
N/A	1 x double 1390mm x 1900mm



***IMPORTANT:** The calculated weight is an estimation only. The estimation is based on the weight that similar motorhomes have (left hand drive). The calculation of the weight includes; 90% of fuel in the tank, 1 gas bottle, 50 litre fresh water, 1 person to drive (75 kg), 10 kg luggage. The Maximum User Payload includes: a) conventional load (this is the allowance for passengers) b) essential habitation equipment (items of fluids required for safe and proper functioning of habitation equipment) c) optional equipment (items available from the manufacturer over and above the standard specification) d) personal effects (those items not effected by the above) Please take care to ensure that you have allowed for the masses of all the items you intend to carry in the motorhome e.g. Passengers, optional equipment, essential habitation equipment and personal effects, such as clothing, food, pets, sailboats, sports equipment etc. The weight of any additional accessories must be deducted from the payload, given that could mean the reduction of the number of passengers. It should be ensured not to exceed the maximum allowable loads on the shafts and technically permissible weight of the fully loaded vehicle.

+ Innovative Construction

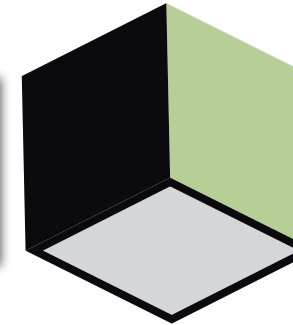

The new concept of motorhome thanks to ISB technology.

The almost complete elimination of wood in the bodywork structure and the use of damp-proof materials, which are extremely effective at isolating, guarantee that the vehicle lasts longer. The thickness of the floor, roof and walls are in an XPS material which is much better at insulating than offered by usual standards.



Angles

- Aluminium Profile
- Damp-proof filler
- Butyl Liner/ Aluminium
- Expanded PVC Profile
- High density XPS damp-proof insulation



Platform 62mm:

- Linoleum Flooring
- Plywood
- Polyester coating
- Expanded PVC Profile
- High density XPS damp-proof insulation

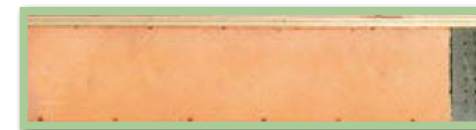

99% Wood-Free Construction

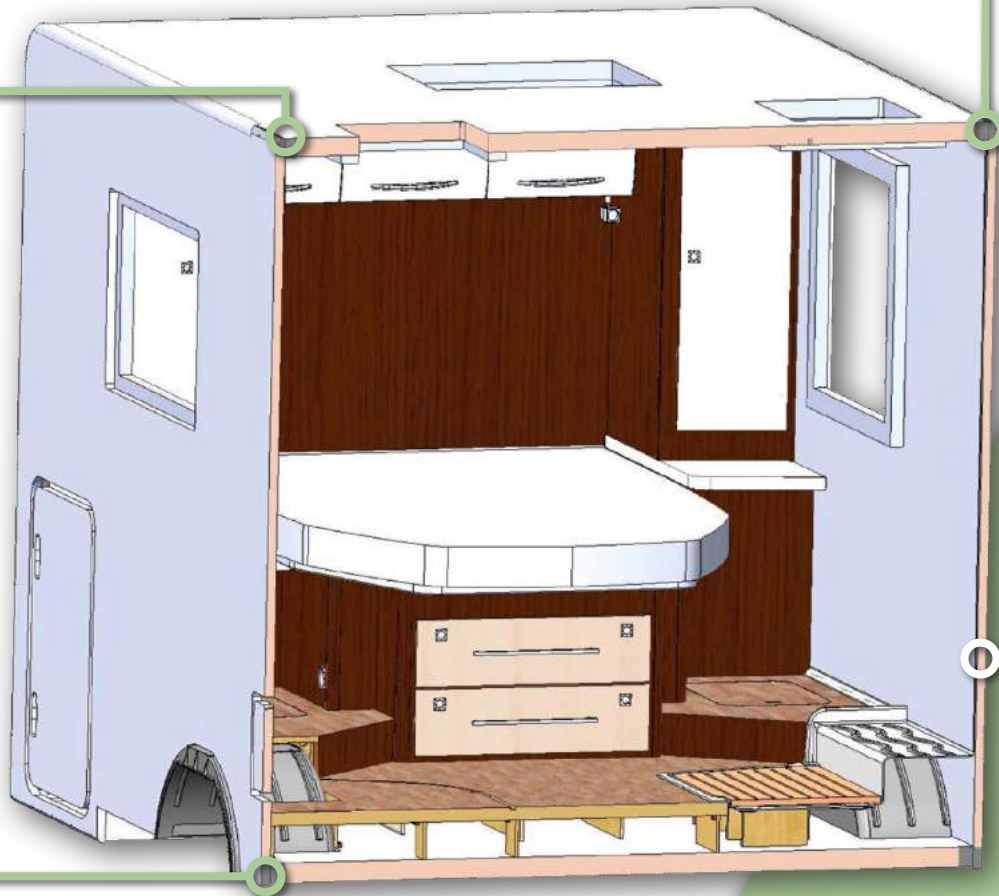

Ceiling 56mm:

- Polyester coating
- Expanded PVC profile
- High density XPS damp-proof insulation
- Polyester coating



Walls 29mm

- Polyester coating
- Expanded PVC profile
- High density XPS damp-proof insulation

All Benimar Tessoro models are covered by a 5-year bodyshell water ingress guarantee and 24 month manufacturer habitation guarantee.



Benimar have been producing motorhomes for nearly 40 years and is today the undisputed leader of the Spanish motorhome market.

In Peñiscola, under the Mediterranean sun and protected by a middle age castle, the Benimar factory has 40,000m² of modern facilities.

Modern tools, high-tech machinery and innovative technologies allow the factory to produce 3000 motorhomes per year.

The double approval ISO 9001 and ISO 14001 warranty guarantee quality and reliability, as well as the conformity of the environmental rules.

All Benimar Tessoro models are covered by a 5-year bodyshell water ingress guarantee and 24 month manufacturer cabin guarantee.

5 YEAR GUARANTEE ON THE WATER INGRESS OF THE BODYSHELL

The 5 year specific guarantee for the water ingress of the bodyshell will come into effect from the date of the registration of the motorhome. This guarantee covers the original bodyshell waterproofing. Only the authorised distributors of the brand are able to decide on the repair or replacement of the faulty elements.

HABITATION GUARANTEE 24 MONTHS

The guarantee covers the labour and parts supplied to replace or repair those found to be faulty completely free of charge for a period of 24 months from the date of registration of the vehicle.

The guarantee given by the manufacturer only applies when the materials have been used correctly in accordance with the recommendations as shown in the Service Manual that is delivered with each vehicle and with the reservation that these materials have been used under normal working conditions.

See warranty booklet information for full details.

FORD WARRANTY - 2 YEARS

A vast amount of design, engineering and expertise ensures that every new Ford vehicle delivers.

To make sure your new Ford continues to deliver to your expectations, Ford have developed a new vehicle warranty programme for new vehicles to minimise down-time. The Ford Warranty is a comprehensive package of benefits designed to meet high standards of aftersales care and support.

Every new vehicle benefits from a Ford Base Warranty that is operated through Ford Authorised Dealers. This warranty covers any part of the vehicle that requires repair or replacement as a result of a manufacturing defect. The part will be repaired or replaced completely free of charge by any Ford Authorised Dealer, regardless of any change of vehicle ownership during the warranty period.

The warranty begins on the day the vehicle is delivered to the first customer.

For full warranty details, please ask your Sales Executive

ADVANCED EMISSIONS CONTROL FOR DIESEL ENGINES

AdBlue®

The Benimar Tessoro 2017 motorhome range engines will feature Selective Catalytic Reduction (SCR) using AdBlue®, a water/urea based additive which is stored in a tank (like diesel fuel), however, unlike fuel it is not injected into the engine, but directly into a specially modified part of the vehicle's exhaust. This begins a chemical reaction which removes the polluting oxides of nitrogen (NOx), converting them into harmless oxygen and nitrogen in a process known as Selective Catalytic Reduction, or SCR for short. SCR is only applicable to diesel engines and the more economically you drive, typically, the less AdBlue® you will use.

Easy AdBlue® Filling

Access from the outside to the AdBlue refill located under the fuel filler.



Important Information

- AdBlue® is not a fuel additive. This is why there is a separate AdBlue® tank
- If you put AdBlue® in your fuel tank by mistake, please do not start the engine, but contact a retailer for help
- Put only AdBlue® in the AdBlue® tank; do not fill the AdBlue® tank with any other liquids
- Prevent anything from contaminating AdBlue®
- If small quantities of AdBlue® come into contact with the vehicle's paintwork, for example, wipe them off and if necessary rinse the area with water

How will I know if the system needs topping-up?

A series of warnings will be given via the driver information system, accompanied by advice/messages. The first message is displayed when the remaining range is approximately 1,500 miles, and is repeated every 62 miles until the range reaches 1,000 miles, at which point the warning turns amber. This warning is repeated every 31 miles and is accompanied by an audible tone. If these warnings are not acted upon, the warning turns red; once this happens the vehicle will not restart once the ignition is turned off. This is not a fault, but a required feature of the system. If this stage is reached the system will need a full top-up before the vehicle can be restarted. Further information is available in the vehicle handbook.



Where Customers Become Friends

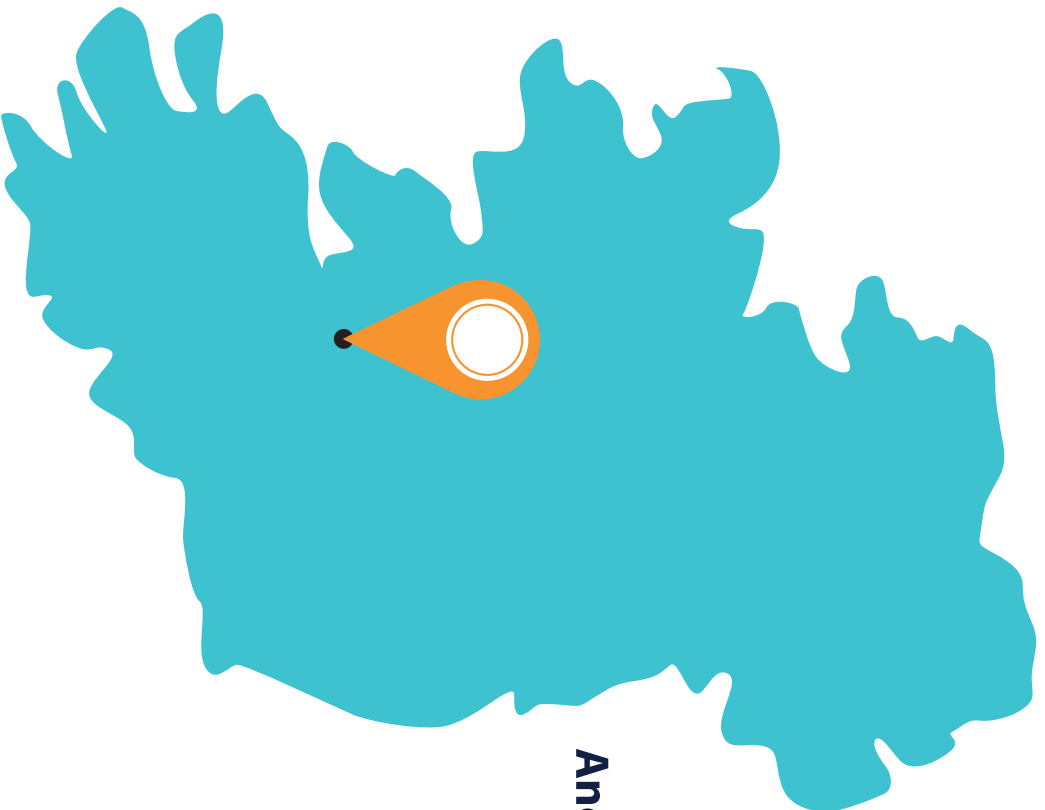

Find us at:

**Anchor Point Motorhomes Ltd,
Shannonside Business Park,
Birdhill,
Co Tipperary**

www.anchorpointmotorhomes.com
Tel: 061 379903 | Email: info@anchorpointmotorhomes.com

This brochure does not constitute an offer by Marquis or Anchor Point Motorhomes. It's the continual policy of Ford and Benina to seek to improve their vehicles in every way and so whilst every effort has been made to ensure the details set out in this brochure were correct at the time of going to press, they are unable to guarantee that no changes in specification have subsequently taken place. They therefore reserve the right to alter any detail of price, specifications and equipment without notice prior to an order being placed. Patents and registered designs pending. Benina designs its motorhomes to provide a variety of potential uses for its customers. Each vehicle features the optimum storage, fluid, seating and sleeping capabilities. While the customer enjoys this potential, they have the responsibility to select the proper combinations of loads without exceeding the chassis weight capacities. Please note that Imperial conversions have been rounded to the nearest inch. Dimensions are based on vehicles with standard wheels. All weights and dimensions are subject to manufacturing tolerances and refer to standard specification models and do not include any options. Effective 1st October 2016, this literature supersedes all others. Marquis Motorhomes is a registered trademark of The Auto-Sleepers Group Ltd. The Ford website contains full information on all Ford products in Ireland, together with details of their environmental and recycling policies. The site address is www.ford.ie.