

EN



Concorde

REISEMOBILE AUS LEIDENSCHAFT



CARVER 850 L

ANNIVERSARY MODEL

40 YEARS OF PREMIUM QUALITY

Step in and step up to the new Concorde class. The name Concorde has stood for absolute premium quality in motorhome construction like no other for more than 40 years now. This applies to the plethora of innovative solutions that distinguish motorhomes built in Aschbach to the same extent as Concorde's immaculate craftsmanship. Evolving from a manufactory,



Concorde models now set the standard in the exclusive, high end motorhome sector. Models like the Carver 850 L, for example, Concorde's new anniversary model. A premium integrated motorhome based on the powerful Iveco Daily Chassis, with equipment that is second to none. Don't just take our word for it - see for yourself.







PASSION FOR MOBILITY

As soon as you enter the living area of the Carver 850 L, you'll be enchanted by the exclusive surroundings and the bright and friendly overall impression. But this motorhome will win you over at second glance as well, with the choice of exclusive, high-quality materials wherever you look - the surfaces of the furniture, the leather upholstery, the curtains or the floor covering. You'll feel comfortable. You'll feel at home. And there are good reasons for this. After all, this motorhome has been developed and built by people who are just as passionate motorhome enthusiasts as you are. It is the passion for mobility that unites us.



FORM AND FUNCTION

Ingenious solutions have characterised Concorde motorhomes for more than four decades. The floor plan and detailed concepts implemented in the Carver 850 L convincingly prove that form and function do not contradict one another, but can coalesce to produce a perfect combination. The L-shaped kitchen with loads of storage space, the generously dimensioned premium bathroom, the comfortable double bed, the innovative lighting concept – there are many convincing arguments in favour of our anniversary model. All good reasons for deciding on this Concorde motorhome.





THE STANDARD

Electric drain valves: another added convenience, included in the standard equipment for the first time. More convenient water disposal than ever before. With the help of a camera, you drive your motorhome into position, directly over the disposal station, and empty your wastewater tank quickly and easily from the driver's seat at the touch of a button.



Electrical package with charging current: so that can maintain your autonomy for longer. With the powerful 400 Ah body battery, the combination charger, the sinusoidal inverter and the 90 A charging converter, you are not only perfectly equipped in terms of capacity, you can also operate the optional air conditioning system for the living area while driving.



HIGHLIGHTS

The comfort and safety package gives you even better control of your Concorde. This includes an active lane departure warning system, rain / light sensors and emergency braking assistant to the same extent as adaptive cruise control and the city break assistant.



The design of the special Carver model can be summed up in just a few words: elegant, modern and distinguished. The high-quality Centurion-style decor is immediately evident, even from the outside. The beige leather upholstery with diamond quilting and 40-year embroidery harmonises perfectly with the Atlas cedar furnishings.



TECHNICAL SPECIFICATIONS

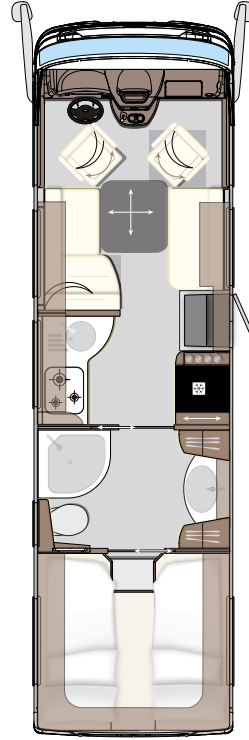

CARVER 850 L

BASIC VEHICLE	Iveco Daily
CHASSIS TYPE	65C18
ENGINE (Euro VI d)	4-cylinder
ENGINE CAPACITY	3,0 l
OUTPUT	132 kW (180 hp)
TORQUE	430 Nm
OVERALL LENGTH (mm)	8590
OVERALL WIDTH (mm)	2400
OVERALL HEIGHT (mm)	3460
WHEEL BASE (mm)	4750
MAXIMUM TECHNICALLY-AUTHORISED GROSS VEHICLE WEIGHT (kg)	6500
MASS IN RUNNING ORDER (kg)	5280
PAYLOAD (kg)	1220
TRAILER LOAD BRAKED (kg)	3500
SEATS WITH THREE-POINT SEATBELT	3 / 4

43.025,- €
PRICE ADVANTAGE

EXTENDED STANDARD EQUIPMENT**PRICE IN EURO
INCLUDING 19% VAT**

Carver 850 L	225.250,00 €
Chassis version Iveco Daily 70C (7,000 kg gross vehicle weight)	2.505,00 €
Chassis package 2 70C ESP, ABS, ASR and hill holder	17.635,00 €
Increased payload of front axle 2,900 kg	1.225,00 €
Engine option 1 Iveco Daily C21 (Euro VI d), displacement 3.0 l, 154 kW (210 hp), torque 470 Nm	2.910,00 €
ZF converter automatic transmission	5.630,00 €
Comfort and safety package	6.170,00 €
Hydraulic supporting jacks with automatic levelling	9.460,00 €
Fuel tank, 120 l	725,00 €
Bi-LED main headlights including LED daytime running lights, fog lights and static cornering lights integrated into the front bumper	1.965,00 €
Concorde multi-function steering wheel in leather, removable	1.950,00 €
Dual-tone compressed air horn	1.025,00 €
Centurion Style package	6.830,00 €
Additional rigging bar in garage at the height of living room floor	345,00 €
Lashing system with airline rails and 4 lashing rings embedded in rear garage floor	605,00 €
Central locking system for storage space flaps with electric opening via sensor	4.320,00 €
6.0 m side wall awning, electric	2.735,00 €
LED side wall lighting beneath the awning	910,00 €
LED lighting for storage areas in the double floor	615,00 €
Front mirror right and left for external coach mirror (long)	575,00 €
External coach mirror (long) in Centurion-style, painted white	640,00 €
Side windows in driver's cabin with insulation glazing and electrical actuation	1.275,00 €
Electrical sun blind in driver's cabin for windscreen	825,00 €
Dashboard and dashboard cover in faux leather, bi-colour "Vanilla / Terra" upholstery	785,00 €
"Privacy" front privacy blinds (adjustable pull-up screen from the bottom upwards)	690,00 €
Midi-Heki instead of Mini-Heki (living room)	785,00 €
Mineral kitchen worktop with seamless sunken sink.	1.720,00 €
177 l compressor refrigerator / microwave combination	2.050,00 €
Roof ventilator with ventilation and aeration	575,00 €
Illuminated acrylic glass plate in front of kitchen window	270,00 €
High-quality design chrome single lever mixer tap for kitchen and bathroom (kitchen with extendable faucet)	215,00 €
Electronic power package "Ultra Power"	10.835,00 €
Charging current package for body batteries	1.780,00 €
Double reverse camera with shutter	1.135,00 €
Solar panels with approx. 3 x 210 W maximum power	5.115,00 €
Satellite TV system I with 24" Full HD LED Smart TV in entrance area	5.675,00 €
24" Full HD LED Smart TV for rear sleeping compartment with integrated TV tuner	1.135,00 €
LTE WLAN router for amplifying external WLAN signals and Internet TV streaming	1.005,00 €
Navigation system (with truck software and 8" touchscreen display)	2.735,00 €
Sound system	1.475,00 €
Acoustic package for rear bedroom	960,00 €
SOG comfort toilet ventilation with activated carbon filter for fixed tank (extraction at toilet bowl)	395,00 €
2400 W roof air conditioning with 1700 W heating element	3.490,00 €
Electric drain valves for grey and black water tank incl. camera	2.690,00 €
Bedroom area / garage heating circuit can be thermally regulated	650,00 €
2-zone floor heating, can be regulated separately (living room, bathroom)	3.025,00 €
6 l Alde-Flow additional hot water boiler	1.015,00 €
Mirrored cabinet in- and outside	180,00 €
Leather upholstery Jubi 40 Vanilla	6.465,00 €
List price (including 19% VAT)	352.975,00 €
Price in Euro (including 19% VAT)	309.950,00 €



Concorde

REISEMOBILE AUS LEIDENSCHAFT



Concorde Reisemobile GmbH
Concorde-Straße 2-4 · D-96132 Schlüsselfeld-Aschbach (Germany)
Phone +49 (0) 9555 9225-0 · Fax +49 (0) 9555 9225-44
Internet: www.concorde.eu · E-mail: info@concorde.eu

All prices of vehicles and optional equipment are in Euro including 20 % VAT and are subject to purchase and admission in the UK. Price adjustments due to increase of the VAT are reserved. All prices are recommended retail prices ex works. Price adjustments from the manufacturer of the basic vehicle cause a corresponding additional price. Prices for optional equipment are valid factory-fitted and disposal in time. Late installations cause additional material and construction costs. Prices include additional charges for chassis freight and TÜV approval. Technical modifications reserved provided that the overall product quality remains the same or is improved and the intended purpose is not impaired. On publication of this price list all previous are rendered invalid. Subject to change without notice, errors excepted.

Jubi_EN_Stand: 08/2021