

Credo



Technical Information 2015

Concorde
REISEMOBILE AUS LEIDENSCHAFT

Standard equipment

CHASSIS

IVECO

Daily 50C15

Insulated and soundproofed engine compartment cover	•
Turbo diesel engine with rear wheel drive and twin wheel rear axle	•
Electronically controlled common rail direct injection	•
6-speed transmission	•
Traction control (ASR)	•
Tyres	195 / 75 R16
Rear axle tyres with traction tread (M+S)	•
Disk brakes on the front and rear axle	•
Hydraulic braking system	•
Electronically regulated anti-lock braking system (ABS)	•
Cruise Control	•
Full size spare wheel under the rear garage	•
3 phase alternator 14 V / 140 A	•
Fuel tank capacity	90 l
Daytime running light LED	•
Halogen headlamps with lens optic, full beam integrated into the bumper	•
Rear body wall with integrated tail lights	•
Exclusive individual dashboard, incl. trays	•
Dashboard cover in artificial leather upholstery with quilting seam	•
Height adjustable steering wheel	•
Hazard warning triangle, first aid kit, warning lights and wheel chock	•

Standard equipment

BODY

CREDO

Panoramic laminated windscreen	•
Tempered glass sliding double glazed side windows in the cab area, tinted with night blinds (usable as sun shield while driving) and fly screens. Window frames with thermal break	•
Tinted double-glazed acrylic windows in the habitation area with lift or sliding operation and integrated blackout blinds and fly screens	•
Integrated step in front bumper for windscreen cleaning	•
Central towing eye in front bumper	•
Electrical operated insulating shutter for front windscreen	•
Highly stable, durable aluminum composite construction "Solidtherm"	•
Thermal-bridge-free, fully insulated wall-joint technology using high-density solid PU profiles	•
Completely insulated driver's cab	•
32 mm wall, roof and under floor thickness, of which 30 mm closed-cell RTM hard foam, 40 mm roof of which 38 mm closed-cell RTM hard foam	•
Walls, roof and floors internally and externally in high-quality sandwich design aluminium	•
Side walls in sheet smooth, white stove-enameled	•
Fully accesible roof	•
Aluminium roof moulding with rain water channels to reduce staining to the side walls	•
Front mask constructed from highly stable corrosion resistant fiberglass composite material	•
Side skirting panels constructed from highly stable corrosion resistant fiberglass composite material	•
Rear wall and bumper made of fiberglass composite sandwich with PU foam core	•
Heated under floor storage area beneath living room floor in lightweight construction, with approx. 350 mm height external access locker doors	•
Illuminated rear garage with garage doors driver and passenger side, lashing system	•
Illuminated internal entry step with heating	•
External electric retractable entrance step with safety circuit breaker	•
"Security" entrance door with remote control entry and emergency key switch	•
Fly screen for entrance door	•
External awning light with security switch (automatic switch-off when the engine starts)	•
Pilot cab seats with integrated seatbelt safety system and arm rests	•
Large shoe compartment in the entrance area	•
Rear garage floor with checker plate aluminum sheet cover	•
Coach style external wide-angle, electronically heated and adjustable side mirrors (short version)	•
Double floor sandwich construction underfloor 38 mm, living room floor 30 mm low weight construction	•
Rear-axle wheel arches in fully in insulated sandwich construction	•

Standard equipment

LIVING ROOM / BEDROOM AREA

CREDO

Furniture in Wenge (coating on both sides) with roof cabinet fronts in "High Gloss" Senosan cream white	•
One Level living space floor from the dashboard through to the rear bed	•
Colour coordinated, high-quality textile coverings for walls and ceiling	•
Extreme stabile floor covering in Soft-walk. Colour: "Yacht" flooring effect	•
Living room suite ergonomically formed high-quality textile / microfibre upholstery with zips (body) incl. driver's cab seat	•
Multi-function couch on left side with seat belt	•
High-quality roman blinds in textile	•
Rear bed with bed base, adjustable head section and comfortable cold foam mattress	•
Midi-Heki with fly-screen and pleated shade in living room	•
Mini-Heki with fly-screen and pleated shade in bedroom area	•
High-quality dining table	•
TV sideboard in entrance area	•
Entrance cabinet incl. a collection of glasses and LED lighting	•
Robust metal entrance handle for boarding assistance	•
1 x 12 V socket (living room) and 2 x 230 V sockets (1 x living room and 1 x bedroom)	•
Front wall units over the full width of the windscreen	•

PULL-DOWN BED (OPTIONAL)

Bed size (in mm)	1950 x 1300
Height above bed (in mm)	860
Comfortable cold-foam mattress with bed base	•
Mini-Heki with fly-screen and pleated shade	•
Driver's cab curtains	•

Standard equipment

KITCHEN

CREDO

Kitchen area with splashguard	•
Mineral kitchen worktop in lightweight design with stainless-steel sink. Colour: brilliant white	•
Stainless-steel hob, three rings with automatic ignition and glass cover	•
Chrome optic single lever mixer tap	•
160 l refrigerator with separate freezer box, AES (automatic energy selection 12 V / 230 V / gas)	•
Drawers with Servo-Soft movement	•
Integrated cutlery drawer	•
Mini-Heki	•
LED light rail beneath the side cupboards	•
Integrated waste bin system in lower kitchen cupboard	•
2 x 230 V socket	•
Kitchen apothecary cabinet for cooking utensils	•

BATHROOM / TOILET

Plexicor bathroom worktop with a seamless integrated washbasin. Colour: arctic white	•
High-quality chrome optic mixer tap on washstand	•
Separate shower with acrylic-glass doors incl. removeable clothes rail	•
Shower fittings with wall mounting and height adjustable shower head	•
Cassette toilet with porcelain bowl	•
Bathroom fittings with toilet paper holder and hand towel hooks	•
Mini-Heki with fly screen and pleated shade	•
LED spotlight lighting	•
Wardrobe with interior lighting	•
Dressing mirror	•
Spacious mirrored cabinet with shelves	•
230 Volt socket	•

Standard equipment

WATER / GAS / HEATING

CREDO

Gas bottle compartment for 2 x 11 kg gas bottles	•
Gas controller "Duocontrol" with crash sensor and automatic bottle changing	•
Sink siphon	•
Fresh- and waste water tank, each approx. 140 l located in heated double floor	•
Convenient waste water tank drainage with drain cock in the heated double floor, quick release fixing units on drain valves	•
External cleaning opening on all tanks, accessible from the living area	•
Waste water drain hose with quick release connections	•
Automatically functioning central water-pressure pump with filter system	•
Alde hot water-gas-central heating 5500 W with a thermostat and timer, electrical heating cartridge 230 V, 3000 W backflow lock with integrated hot water boiler to maintain all tapping points	•

ELECTRICAL / TV / RADIO

Gel battery 1 x 140 Ah	•
230 Volt CEE connection in storage space with cable routing through the vehicles twin floor	•
RCD automatic personal protection	•
Automatic charging with electronic control and battery temperature sensor, maximal charge current 25 A	•
Inverter from 12 V to 230 V Sinus 300 W with mains priority circuit	•
Disconnection of the electrical system by under-voltage with automatic restarting function	•
Double DIN radio CD/DVD and MP3 and USB ports, 2-way Speaker system	•
LED lighting to internal fittings	•
Service friendly access to electrical system with grate-cover in the rear garage	•
Automatic chargeover of refrigerator when engine is switch off, from 12 V to gas (15 min Delay after engine stops) / (230 V when on a land connection)	•
Automatic charging of the habitation and vehicle's batteries from engine alternator whilst engine is running	•
1 x 230 V socket at the control center	•
Circuit breaker for leisure batteries	•
Automatic disconnection and connection of leisure and vehicle batteries	•

ON BOARD ELECTRONICS

CREDO

- Highly modern microprocessor-controlled electrical system with BUS-technology (Binary Unit System)
- Centralized control panel with 4.8" touchscreen colour-display

-
-

Select buttons for switching on and off the following devices:

- Panel
- Lighting
- Water pump
- Heating

-
-
-
-

LCD display for monitoring:

- Freshwater tank (fill level in %)
- Wastewater tank (fill level in %)
- Battery voltage of the vehicle battery and leisure battery
- Charging and discharging current
- Outdoor and indoor temperature
- Exterior current supply
- Battery parallel circuit
- Date and time with alarm function

-
-
-
-
-
-
-
-

Warning system for:

- Wastewater tank full
- Freshwater tank empty
- Battery under-voltage
- Reserve gas bottle in use
- Extended entrance step

-
-
-
-
-

Technical specifications

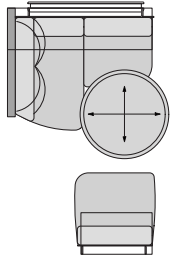

Multi functional seating with 2 seat belts

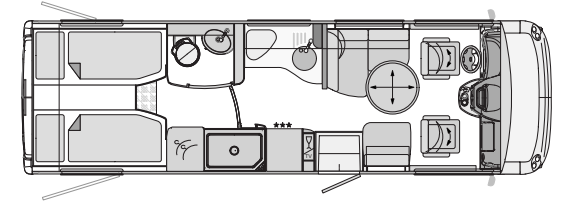
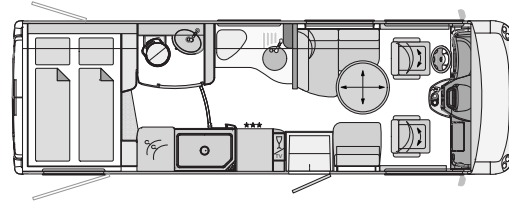

CREDO 761 H

CREDO 791 L

Base vehicle	Iveco Daily	Iveco Daily
Chassis type	50C15	50C15
Engine	4-cylinder	4-cylinder
Engine capacity	3,0 l	3,0 l
Output	107 kW (146 bhp)	107 kW (146 bhp)
Torque	350 Nm	350 Nm
Overall length (mm)	7690	7990
Overall width (mm)	2330	2330
Overall height (mm)	3210	3210
Wheelbase (mm)	4100	4100
Gross vehicle weight (kg)	5200	5200
Mass in running order (kg)	4120	4200
Payload (kg)	1080	1000
Towbar load (braked) (kg)	3500	3500
Seats with seatbelts	3	3
Seating Area left (mm)	1235 / 890	1235 / 890
Bench seat right (mm)	725 / 650	725 / 650
Rear bed (mm)	2050 / 1400	2 x 2000 / 845
Pull-down bed dimensions (optional, mm)	1950 x 1300	1950 x 1300
Height above pull-down bed (mm)	860	860
Garage door right H / W (mm) clearance	1170 x 950	1170 x 950
Garage door left H / W (mm) clearance	1170 x 750	1170 x 750

For further information concerning measurements and weight specifications see page 14.

Technical specifications

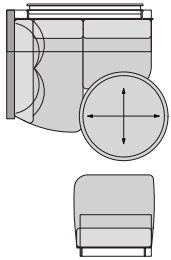

Multi functional seating with 2 seat belts

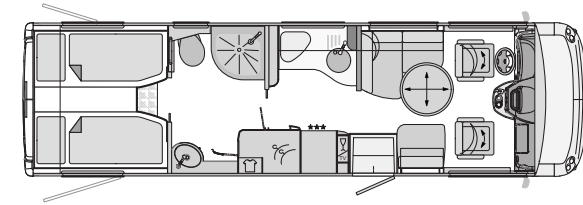
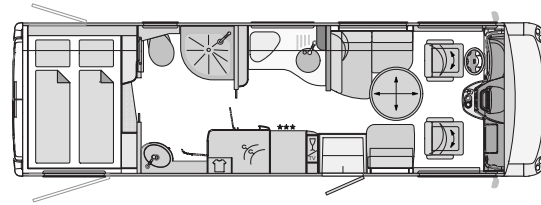

CREDO 790 H

CREDO 840 L

Base vehicle	Iveco Daily	Iveco Daily
Chassis type	50C15	50C15
Engine	4-cylinder	4-cylinder
Engine capacity	3,0 l	3,0 l
Output	107 kW (146 bhp)	107 kW (146 bhp)
Torque	350 Nm	350 Nm
Overall length (mm)	8190	8490
Overall width (mm)	2330	2330
Overall height (mm)	3210	3210
Wheelbase (mm)	4350	4500
Gross vehicle weight (kg)	5200	5200
Mass in running order (kg)	4240	4310
Payload (kg)	960	890
Towbar load (braked) (kg)	3500	3500
Seats with seatbelts	3	3
Seating Area left (mm)	1235 / 890	1235 / 890
Bench seat right (mm)	725 / 650	725 / 650
Rear bed (mm)	2050 / 1400	2 x 2000 / 845
Pull-down bed dimensions (optional, mm)	1950 x 1300	1950 x 1300
Height above pull-down bed (mm)	860	860
Garage door right H / W (mm) clearance	1170 x 950	1170 x 950
Garage door left H / W (mm) clearance	1170 x 750	1170 x 750

For further information concerning measurements and weight specifications see page 14.

Chassis optional equipment

Artikel no.	CHASSIS IVECO DAILY	ADDITIONAL WEIGHT in kg
706012-15	Chassis paket 50C Gross vehicle weight ratio 5600 kg Differential lock for rear axle, air conditioning cockpit, Original Iveco air suspension on the rear axle with the function of "lifting and lowering"	70
1250582-15	Gross vehicle weight ratio 5600 kg	0
700048-15	Tow bar with towable mass 3500 kg (Agile 2500 kg) (only available factory fitting)	29
700041-15	Tow bar with removable ball head max. 2500 kg	33
125052-15	Iveco Daily C 17, engine displacement 3.0 liters, 125 kW (170 hp), torque 400 Nm	0
125024-15	Automatic 6-speed transmission Agile incl. hill climb assistance (towable mass 2500 kg)	20
105060-15	ZF converter automatic transmission (available from the beginning of February 2015)	15
7000941-15	Hydraulic - supporting jacks with automatic leveling	100
702235-15	Stainless steel hubcaps	5
702217-15	Alloy wheels 16", front axle with wheel spacers/rear axle hubcaps (spare wheel with steel rim) front 225 / 65 R16, rear 195 / 75 R16	-4
703400-15	Concorde steering wheel in leather	1
703411-15	Concorde steering wheel in leather removable	2
125075-15	Original Iveco air suspension on the rear axle with the function of "lifting and lowering"	25
125060-15	Differential lock for rear axle	15
125070-15	Driver's cab air-conditioning	30
105080-15	Dual pressure air horn	3

Body optional equipment

Artikel no.	BODY	ADDITIONAL WEIGHT in kg
705220-15	Central locking system for storage space flaps (without the skirting panel flaps and the gas locker door)	5
710112-15	Side wall awning 5.5 m, with crank (761 H / 791 L / 790 H)	54
710113-15	Side wall awning 5.5 m, electric (761 H / 791 L / 790 H)	60
700137-15	Side wall awning 6.0 m, with crank (840 L)	62
7001371-15	Side wall awning 6.0 m, electric (840 L)	66
7001931-15	Electrical sunblind in driver's cab for windscreen	5
7003841-15	Coach wiper system	15
700172-15	Thermo insulated windows in cockpit, side windows electrically operated	3

LIVING ROOM / BEDROOM AREA

839850-15	Multi-function couch with two seats with two secured seat belts (for 4 people)	24
710208-15	Pull-down bed with mechanical operation and Lattoflex, bed base instead of front wall unit	45
706090-15	Midi-Heki instead of Mini-Heki (bedroom area)	6
7007544-15	Panorama skylight instead of Midi-Heki (living room)	13
7007542-15	Panorama skylight instead of Mini-Heki (bedroom area)	19
7001912-15	Front privacy screen (adjustable pull-up screen from the bottom upwards)	4

KITCHEN

7008081-15	Refrigerator 190 l instead of 160 l series refrigerator	6
7008082-15	Refrigerator 190 l / oven combination with grill instead of 160 l series refrigerator	23
705350-15	Roof ventilator	4

Body optional equipment

Artikel no.	ELECTRICAL	ADDITIONAL WEIGHT in kg
710501-15	Electric power paket 1 1 x gel battery 140 Ah additional (a total of 2 batteries) combination-charge 60 A, Sinus inverter from 12 V to 230 V, 2500 W max and 1200 W continuous power with network compensator	68
701200-15	Alarm system with surveillance of the interior, the garage flaps and the living room door	3
7006845-15	Double reverse camera with shutter (picture through series radio)	4
7007201-15	Solar panels with approx 120 W maximal power	15
7007221-15	Solar panels with approx 2 x 120 W maximal power	30

TV / RADIO / TELEPHONE

	Satelite TV with 85 cm dish, fully automatic tuning, multiple user facilities through TWIN-LNB, Port for second receiver with 12 V / 230 V and antenna socket in sleeping area, sound reproduction possible over radio (total vehicle height approx 100 mm extra)	
710603-15	Satelite TV set 1 with LED flat screen 24" in entrance area	38
710610-15	Internet satelite TV set with LED flat screen 24" in entrance area, set with TV reception, GPS SKEW and internet access	38
710620-15	Navigations system (with truck software and 7.0" touchscreen, integrated radio with DVD, CD and MP3 playback, speaker for telephones with Bluetooth) and double reverse camera with shutter	4
710622-15	Sound system with 2-way speaker in driver's cab, 2 wide band speakers in the living space, sub-woofer, sound-processor	25
710612-15	LED flat screen 22" for rear bedroom area with integrated TV receiver	15
7005102-15	Combination 230 V / 12 V / antenna / socket with cable routing in the floor. Position: in the external storage space on the left next to the entrance door (For optional TV external connection) (Satellite signal exit)	1
700677-15	DVB-T external antenna for reception of terrestrial digital TV (for two TV sets)	2
706346-15	DAB + Digital radio, premium quality sound system with additional added features	3

Body optional equipment

Artikel no.	WATER / GAS / HEATING / BATHROOM	ADDITIONAL WEIGHT in kg
710450-15	External shower unit in the garage (driver's side)	2
700862-15	Diesel pre heating "Motor Caravan" with comfortable continuous heating function (5200 W) incl. timer switch	10
701894-15	Additional freshwater tank, 100 l	11
710460-15	Living room gas alarm (carbon monoxide, propane, butane, narcotic gas)	2
700891-15	Gas tank approx. 80 l with remote gas switch, crash sensor and contents indicator through the control panel display, incl. skirting panel flaps	75
700401-15	External gas socket on the passenger's side (BBQ point)	1
7008301-15	Roof air conditioning 2400 W with heating element 1700 W (vehicle total height plus 130 mm)	34
701823-15	Porcelain toilet with approx. 230 l fixed tank	28
701800-15	Additional cassette toilet with retaining basin	3
7018112-15	SOG toilet ventilation over the roof (for cassette toilet)	1
710410-15	Engine heat exchanger which uses the motor's cooling water to heat the living room	5

Body optional equipment

Artikel no.	UPHOLSTERY / LEATHER / CARPET	ADDITIONAL WEIGHT in kg
809160-15	Textile / microfibre upholstery "Cream"	0
809161-15	Textile / microfibre upholstery "Caramel"	0
809111-15	Leather upholstery "Mother of pearl"	25
809146-15	Leather upholstery "Savanna"	25
809147-15	Leather upholstery "Stone"	25
809228-15	Exclusive leather upholstery "Rustic Grey" (natural material with visual inclusions and different surface optics possible)	25
870100-15	Upholstery textile / microfibre with "Redonda" foam-optic	0
870000-15	Upholstery leather with "Redonda" foam-optic	0
860000-15	Concorde Collection: 2 x small pillow, 1 x big pillow, 2 x blankets	8
70015510C-15	Linked and removable living space carpet. Colour: cream	10
70015510G-15	Linked and removable living space carpet. Colour: grey brown	10

Concorde exclusively uses high-quality fabric and leather with a special stain resistance coating.

The mass in running order consists of the dry weight with standard equipment plus: driver (75 kg), full fuel tank, 100 l fresh water in driving position, 1 x full 11 kg steel gas bottle, tool kit and spare wheel. Installing optional extras and accessories may alter the unladen weight and dimensions. All dimensions and weights correspond to the information available at the time of printing. Deviations of +/- 5% are possible and permitted.

Sectional drawing

CONCORDE CREDO CABIN CONSTRUCTION

In motorhome construction, Concorde stands for perfect insulation and outstanding stability. This is primarily down to the lack of thermal loss, completely sealed "Solidtherm" cabin construction with polyurethane ridged foam ledges as well as the insulation of the side walls with 38 millimeter strong RTM foam. And as if that wasn't enough: Also the double floor construction are finished in a sandwich type construction and filled with a total of 70 millimeters of insulation. The exterior side skirting panels, bumpers, front and rear masks are formed from highly stable and nonetheless elastic fiberglass composite materials. The high gloss and flush wall surfaces are made from Aluminium sandwich construction make for a car-like impression. Aluminium roof profile ledges with rainwater flow channels reduce the telling sidewall staining. We give a 10-year water ingress warranty on the body against ingress of moisture from the outside in combination with annual inspection plan in accordance with the Concorde warranty conditions.

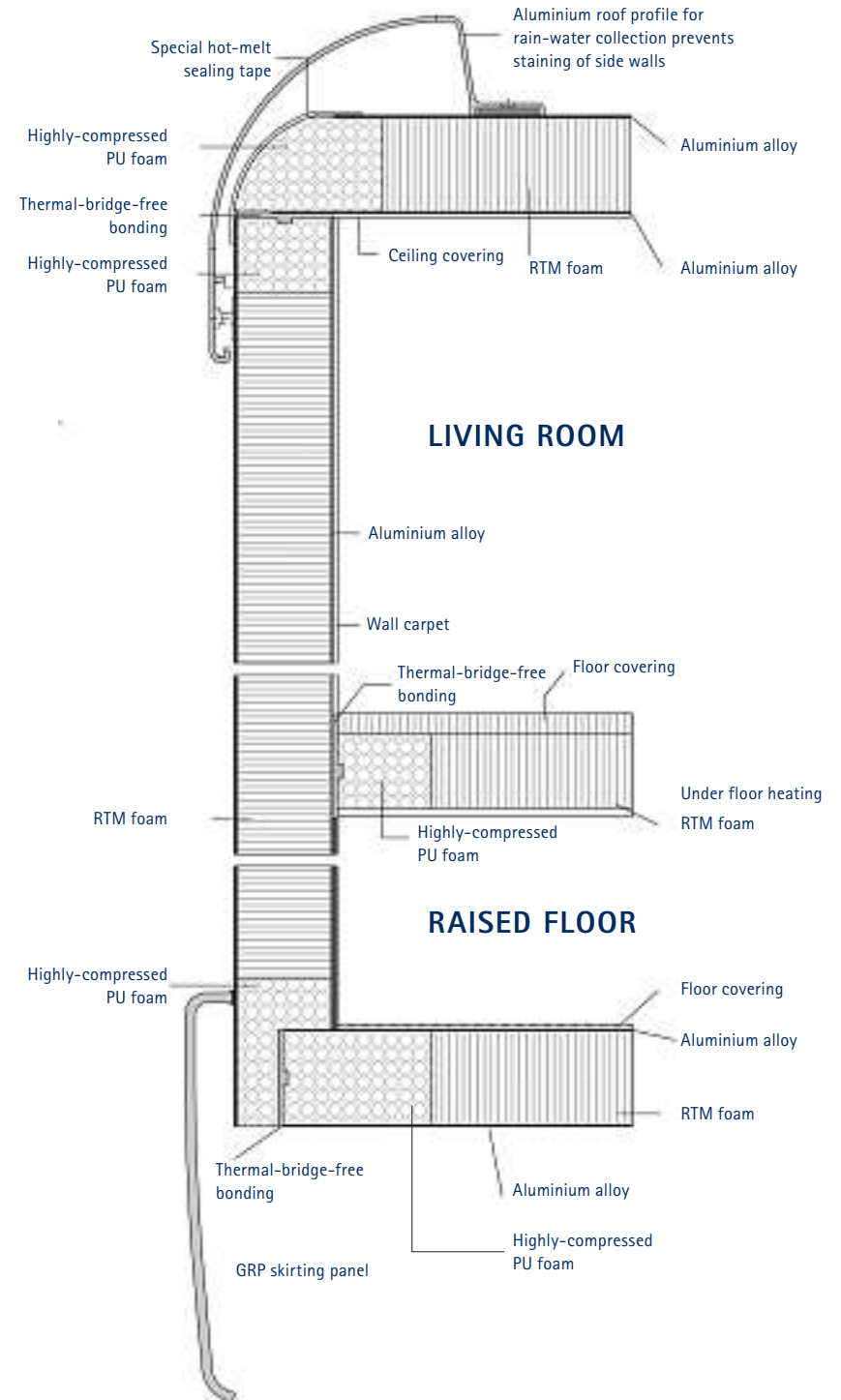

Technical modifications reserved provided that the overall product quality remains the same or is improved and the intended purpose is not impaired. On publication of this technical information, all previous are rendered invalid. Subject to change without notice, errors excepted.

Concorde

REISEMOBILE AUS LEIDENSCHAFT

Concorde Reisemobile GmbH
Concorde-Straße 2-4, D-96132 Schlüsselfeld-Aschbach
Tel.: +49 (0) 9555 9225-0, Fax: +49 (0) 9555 9225-44
Web: www.concorde.eu, E-Mail: info@concorde.eu